

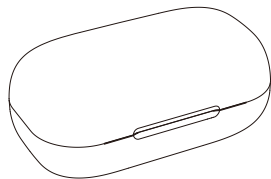

M1

User manual

Accessories



charging case



Eartips



M1 Earbuds

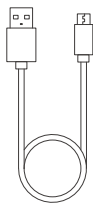

Charging cable



Quick start guide



☑ **Select one earbud as main earbud**

Remark: Make sure the other earbud is in the charging case



☑ **Quick press 2 times MFB**

Red/Blue LED blinking and you will hear "Pairing"

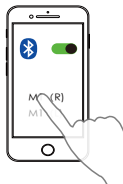

☑ **Search the bluetooth list from device, and choose "M1(R) or (L)"**

You will hear "connected" Pairing is done and succeed. If require, Please input "0000" as bluetooth password



☑ **Pick up the other earbud from charging case**

You will hear "Power on" and "TWS connected"

M1 remember devices it's not necessary to Repair, Enable bluetooth on your device, it'll reconnect automatically.

Note: All calls will be heard in the Main earbud only.

Best fit & best sound

Try all the ear tips to find the best fit and the best sound. The fit is right when you get a complete seal, the ear tips feel comfortable, and you get the best quality and loudest sound.

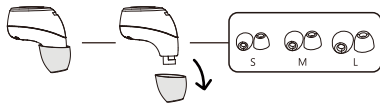

Insert the earbuds with the ear tip directed towards your ear canal. Twist gently until fit comfortably and feel secure in your ear.

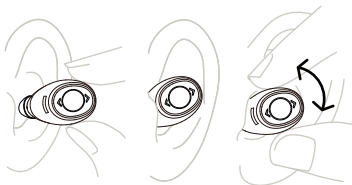

Tip: More than one ear tips size may fit you. Choose the one that completely seals your ear canal for the best sound. You may need different size ear tips for left and right.

M1 basics

Power On/Power off

Pick up earbuds from the charging case , earbuds will be power on automatically, you will hear "Power on"Put the earbuds into the charging case, earbuds will be power off and start to charge, you will hear "Power Off"

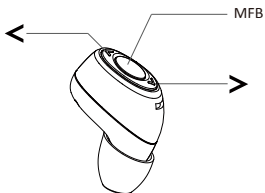

MFB	Accept Call/Reject Call	Short press MFB
	Redial Last Call	Press MFB twice
	Play/Pause Music	Short press MFB

	Volume"+" Short press		Volume"-" Short press
	Previous song Long press		Next song Long press

Charge the earbuds

Put the earbuds into the case.

Push back the case until it is completely closed.

The earbud green light turns on when it is charging and light turns off when it is completely charged.

Charge the case

Charging the case by plugging in the charging cable. The case light turns on when it is charging.

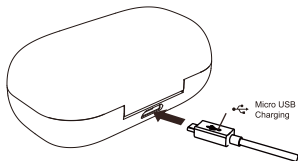

Charge level

Your earbuds let you know when your battery level is low. Every 20 seconds you will hear "Battery low" when there is 2 minutes of battery level.

Earbud status lights

Status	Color
Charging	Red
Fully charged	Off

Case status lights

When your case is plugged into a charge cable for charging , you will see charging lights.

Charging	Slow blinking blue
Full charge	Steady blue light

Note: Your battery is designed to last life of the product. It should only be removed by a recycling facility. And attempt to remove or replace your battery will damage the product and void your warranty.

Basic Specifications of Earphone

Size: 23.6×16.5×26.7mm

Weight: 4.5g

Earbuds Charging Current:55mA

Earbuds Charging time: 1 hour

Working Voltage: 3.3V~4.2V

Standby time: about 40 hours Music Time:2~2.5 hours

Talking Time:2 hours

Bluetooth version: Bluetooth 4.2

Support Profile: HSP, HFP, A2DP, AVRCP

RF transmit: Class-2

Transmission Range (Hz): 2.40GHz ~ 2.48GHz

Transmission distance: 10m

Audio sampling accuracy: 16bits

Audio sampling rate: 44.1~48kHz

Audio encoding format: CVSD、MSBC、SBC、AAC

SNR: >95dB

Working temperature: -15℃~+60℃

Working humidity: 10%~85%(in a non-frozen state)

Earbud Speaker Specifications

Speaker specifications / mode: Φ6mm

Impedance: 16Ω/ TYP.

Frequency(Hz): 20Hz~20KHz

Sensitivity: 93±3dB

Input Power: 2.0mW (Normal), 5mW (Maximum)

Earbud MIC Specifications

1.MIC type: Silicon MIC

2.MIC sensitivity: -42±3dB

3. SPL: 130dB

Basic Specifications of Charging Case

Size: 59*34*24mm Weight:27g

Charging Port: Micro

Charging base(Full) provide power to earphone: 2 times

Charging time : 2hrs

Safety instructions for use

To avoid hearing damage, keep the volume at a moderate level. Avoid listening to music at loud volume levels for prolonged periods of time as this may cause permanent hearing damage or hearing loss.

Do not use M1 when it is unsafe to do so. For example, while operating a vehicle, cycling, crossing a road, or any activity which requires your attention and ability to hear.

Note: If you are watching video while using your earbuds, your audio may be slightly out of sync with your device.



Safety Warning

Please disconnect the USB cable after charging. Product should not be charging in a long time.

Please use the charger or adaptor with output voltage and current(max) 5V/1A or 5V/1.5A and product original charging cable for the product charging. If the output voltage and current of the charger exceeds the requirement, it will cause severe damage to the product, and the product warranty will be invalid.